



NH3 Servo Signal Chopper Instructions

For Installation on Micro-Trak NH3 Plumbing Panels

(For use with GS-2 System)

1. Locate the NH3 Servo Valve 3-Pin W/P Shroud. *See Illustration 1.*
2. Disconnect the 3-Pin Connector. *See Detail A in Illustration 1.*
3. Install the Servo Signal Chopper Module between the male and female ends of the Servo Valve connectors. *See Illustration 1.*

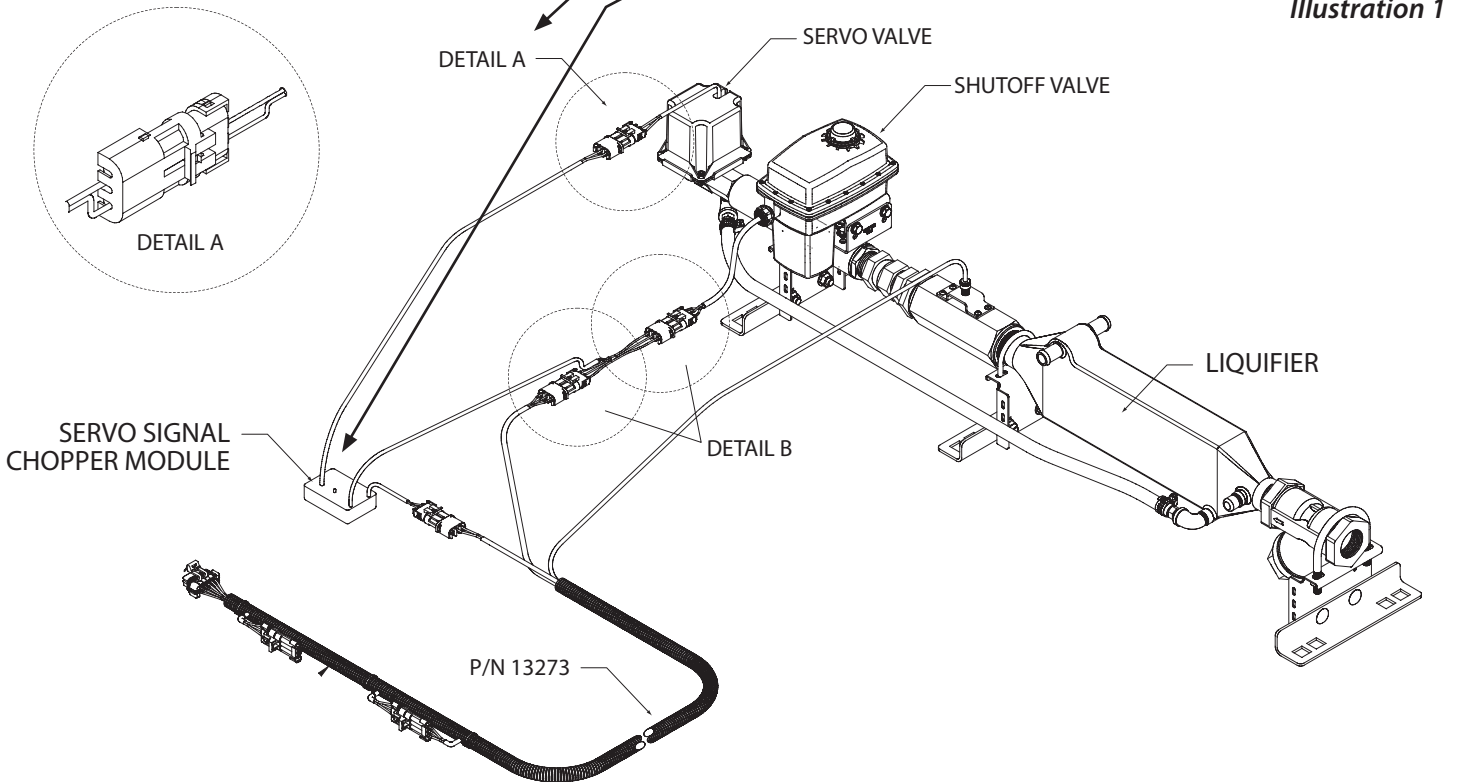

NH3 System Diagram after Servo Signal Chopper Module Installation

4. Locate the Shutoff Valve 3-Pin Connector.
5. Disconnect the 3-Pin Connector
6. Connect the Power Cable from the Servo Signal Chopper Module to the Connectors from the Shut-off Valve and Harness. *See Detail B in Illustration 1.*
7. This completes the Servo Signal Chopper Module Installation.

